

A stylized flame logo consisting of three wavy, overlapping shapes. The top shape is light gray, the middle one is a darker gray, and the bottom one is a very light gray. The flame itself is composed of three horizontal, wavy stripes in a gradient of colors: yellow at the top, orange in the middle, and red at the bottom.

suprme

Table of Contents

ZERO CLEARANCE FIREPLACES

| | |
|---------------------------|-------|
| Galaxy Modern | 4-5 |
| Galaxy Classic | 6-7 |
| Galaxy Contemporary | 8-9 |
| Astra 24TD | 10-11 |
| Astra 24CF | 12-13 |

SEE-THROUGH FIREPLACES

| | |
|----------------------|-------|
| Duet | 14-15 |
| Duet 4 Seasons | 16-17 |

SEE-THROUGH STOVE

| | |
|--------------|-------|
| Vision | 18-19 |
|--------------|-------|

FIREPLACE INSERTS

| | |
|-----------------|-------|
| Fusion 18 | 20-21 |
| Fusion 24 | 22-23 |

| | |
|------------------------------|-------|
| Exclusive Features | 24-25 |
| Dimensions | 26-28 |
| Framing Specifications | 29-30 |
| Our Commitment | 31 |

Note:

Information and images contained in this catalog are subject to change and should be used for reference only.

All installations should be done in accordance to the specifications detailed in the owner's manual.

THE FUTURE OF FIRE

As the industry leader of clean burn technology, we have been creating heating solutions that combine unmatched engineering sophistication, quality craftsmanship and timeless appeal for more than 30 years.

Our products boast patented mechanisms that support unparalleled functionality and environmentally responsible performance.

Our diverse collection ranges from classic designs to contemporary styles, ensuring seamless integration into any decor that will enrich your home with comfort and warmth for a lifetime.





GALAXY MODERN

Zero Clearance Wood Burning Fireplace



The award-winning Galaxy wood-burning fireplace with Modern surround offers stellar comfort and contemporary style. With a single row of louvres, it is a discreet yet chic addition to any interior decor.

Among the industry’s largest and most efficient EPA fireplaces, the Galaxy can heat up to 2,500 square feet to the tune of 100,000 BTUs per hour. It also boasts many exclusive features such as a stainless steel firebox for quick heat transfer and a built-in barbecue grill to cook succulent meals over embers.

Ingenious technology is incorporated in form of an easy-light function and automatic air-control systems for smooth ignition and consistent, long-lasting burns.

Launch into a new universe of contentment with the Galaxy.

| | | | | |
|-----------------|------------------|---|------------------|---|
| SPECIFICATIONS* | Heat Capacity | 2,500 square feet | Certifications | EPA 28 & 5G option 3, CSA B-415.1.10, UL 127-2011 and ULC S610-M87 |
| | Max. Heat Output | 100,000 BTUs/hour (based on a 33 lb load of wood) | Emissions | 3.5 g/hr with EPA method 28 & 5G 2.2 g/hr with CSA method B-415.1.10 |
| | EPA Firebox Size | 3.1 cubic feet | Glass Dimensions | 22 ¾" x 15" |
| | Chimney | 6 inch listed to UL 103/ ULC S629 standards | Patent Numbers | 9/605,851, 7/325,547 & 9/476,593 |

*Same specifications for Classic and Contemporary

GALAXY CLASSIC

Zero Clearance Wood Burning Fireplace



Introduce a universe of comfort to your home with the Galaxy wood-burning fireplace. With its two rows of louvers and ample stainless steel firebox offering a generous view of the flames, the Classic surround is a beautiful centerpiece for any room. Its timeless style, combined with cutting-edge technology and fine craftsmanship, results in a fireplace that will perform for a lifetime.

The Galaxy efficiently warms spaces of up to 2,500 square feet with its powerful blower system. It has also won the prestigious Vesta Award, thanks to several patented technologies and exclusive features, such as the easy-light function, a built-in barbecue grill, and an automatic air control for smooth ignition and consistent, long-lasting burns. This superior functionality also ensures it meets the highest EPA emission requirements, making it an eco-friendly option for your home.

Explore a new frontier of sophisticated home heating with the Galaxy.





GALAXY CONTEMPORARY

Zero Clearance Wood Burning Fireplace



With a tastefully discreet surround, the Galaxy is a wood-burning fireplace that has universal appeal. A product of patented technologies and masterful craftsmanship, it is guaranteed to become a comforting centerpiece in your home that will last a lifetime.

Generous views of the flickering flames can be enjoyed through the glass of the stainless steel firebox, one of the industry's largest. The fireplace's performance is also unrivalled; it quickly warms areas of up to 2,500 square feet with a heat output of 100,000 BTUs.

Its super functionality is complemented by user-friendly innovations including a patented air control system and easy-light feature. Home cooks will also love the built-in grill that allows delicious meals to be barbecued over the coals.

Step into a new world of luxurious heating with the Galaxy Contemporary.

Astra 24TD

Zero Clearance Wood Burning Fireplace

The Astra 24TD wood-burning fireplace is a versatile way to introduce modern comfort and ambiance to your home.

The ingenious design of the compact chamber ensures that the Astra 24 can seamlessly integrate into an existing wall space to replace an old decorative fireplace without the need for costly renovations. Its wide glass door draws focus to the beauty and romance of the dancing flames. Patented ignition and air-control systems allow spaces of up to 1,500 square feet to be warmed with ease.

The Astra 24TD is the flexible answer for homeowners wanting a new level of luxurious heating.

| | | | | |
|-----------------|------------------|---|------------------|--|
| SPECIFICATIONS* | Heat Capacity | 1,500 square feet | Certifications | EPA 28 & 5G option 3, CSA B-415.1.10, UL 127-2011 and ULC S610-M87 |
| | Max. Heat Output | 75,000 BTUs/hour (based on a 33 lb load of wood) | Emissions | 1.8 g/hr |
| | EPA Firebox Size | 2.4 cubic feet | Glass Dimensions | 24" x 13½" |
| | Chimney | 6 inch listed to UL 103/ ULC S629 standards | Patent Numbers | 7/325,547 & 9/476,593 |

*Same specifications for Astra 24CF





ASTRA 24CF

Zero Clearance Wood Burning Fireplace

With its contemporary clean face and minimal frame, the Astra 24CF draws focus to the beauty and romance of the dancing flames while providing cutting-edge heating technology.

Thanks to its compact depth it can seamlessly be installed into an existing wall to replace an old decorative unit while providing all the visual appeal of a large fireplace.

Its patented ignition and air-control systems can effortlessly heat large areas of up to 1,500 square feet while producing clean, consistently burning fires. The Astra's high efficiency is also matched by its environmental credentials with an EPA certification of 1.8 g/h.

Cast-iron panels line and protect the robust stainless steel firebox and contribute to the fireplace's extreme durability. This allows heat to be retained and transferred more effectively, resulting in longer-lasting warmth.

The Astra 24CF is the versatile fireplace of choice for discerning homeowners.

DUET

See-Through Wood Burning Fireplace

The Duet see-through fireplace is a lyrical expression of cutting-edge contemporary design. As the only double-sided wood burning fireplace to meet the EPA’s most exacting emission standards, it confirms Supreme’s position as the industry leader of clean burn technology.

The Duet doubles as a visually compelling feature in any interior scheme, whether installed as a centerpiece or as a decorative divider between two rooms. Several patented technologies ensure user-friendly ignition that can effortlessly warm spaces of 2,000 square feet. A dual air-wash system keeps both glass panels clean, even on low-burn settings, while the unique baffle design prevents smoke escaping when either door is opened.

The Duet will introduce a sense of harmony along with superior heating capability to your home.

| | | | | |
|-----------------|------------------|---|------------------|---|
| SPECIFICATIONS* | Heat Capacity | 2,000 square feet | Certifications | EPA 28 & 5G option 3, CSA B-415.1.10, UL 127-2011 and ULC S610-M87 |
| | Max. Heat Output | 100,000 BTUs/hour (based on a 33 lb load of wood) | Emissions | 3.6 g/hr with EPA method 28 & 5G 2.2 g/hr with CSA method B-415.1.10 |
| | EPA Firebox Size | 3.1 cubic feet | Glass Dimensions | 22¾" x 15" |
| | Chimney | 6 inch listed to UL 103/ ULC S629 standards | Patent Numbers | 9/605,851, 7/325,547 & 9/476,593 |

*Same specifications for Duet 4 Seasons





DUET 4 SEASONS

See-Through Wood Burning Fireplace

The Duet 4 Seasons see-through fireplace is perfectly attuned to modern tastes. By installing the fireplace so that one side heats an interior room while the other faces onto an outdoor area, you can enjoy more spaces within your home all year round.

A generous firebox fits logs of 24 inches that can be loaded in from either door. This feature is particularly convenient when serving flavorsome barbecued meals prepared on the drop-down grills. The Duet's superior performance is underpinned by several patented technologies such as the unique baffle design that prevents smoke from escaping when either door is opened and a dual air-wash that keeps the glass panels clean, even at low burn settings.

The Duet 4 Seasons sets the stage for flexible living and sumptuous comfort in any home.

Note: Please consult with your dealer when installing this unit in a colder climate region.

VISION

See-Through Wood Burning Stove



As the industry's first and only see-through wood burning stove, the Vision is a masterpiece of engineering foresight. Its free-standing form upends conventional thinking that a hearth needs to be set in or against a wall.

With glass panels on two sides displaying a generous view of the flames, the Vision offers double the pleasure and comfort of a traditional stove. Patented ignition and air control systems ensure optimum performance and unparalleled functionality. While the firebox can accommodate logs of up to 24 inches, its compact depth ensures it doesn't overwhelm when installed as a centerpiece.

The Vision is the perfect choice for consumers who wish to introduce flexible, contemporary heating design to their home.

SPECIFICATIONS

| | |
|------------------|---|
| Heat Capacity | 2,000 square feet |
| Max. Heat Output | 100,000 BTUs/hour (based on a 33 lb load of wood) |
| EPA Firebox Size | 3.1 cubic feet |
| Chimney | 6 inch listed to UL 103/ULC S629 |
| Certifications | EPA 28 & 5G option 3, CSA B-415.1.10, UL 127-2011 and ULC S610-M87 |
| Emissions | 3.6 g/hr with EPA method 28 & 5G 2.2 g/hr with CSA method B-415.1.10 |
| Glass Dimensions | 22¾" x 15" |
| Patent Numbers | 9/605,851, 7/325,547 & 9/476,593 |

Available Colors:



Metallic Black



Charcoal



Mojave Red



Honey Glo Brown



Almond



Stainless Steel





FUSION 18

Wood Burning Fireplace Insert

The Fusion 18 is the ideal wood burning insert for people wanting to improve the efficiency of their fireplace. Its sleek design and innovative technologies introduce comfort, without forfeiting the beauty of the existing masonry.

While it is the compact model of the Fusion series, it nonetheless offers a generously proportioned firebox and viewing panel that ensures the compelling beauty of the fire is the centerpiece on show.

The Fusion’s cutting-edge style is equaled by the sophistication of its engineering. Patented ignition and air-control systems result in impressive functionality.

The Fusion 18 meets the highest EPA emission standards, making it ideal for homeowners wanting to convert an energy-draining fireplace into an eco-friendly, efficient heat source.

| | | | | |
|----------------|------------------|---|------------------|--|
| SPECIFICATIONS | Heat Capacity | 1,500 square feet | Certifications | EPA 28R, ASTM E2780, ASTM E2515, CSA B415.1-10, UL 1482 and ULC S628 |
| | Max. Heat Output | 75,000 BTUs/hour (based on a 33 lb load of wood) | Emissions | 1.9 g/hr |
| | EPA Firebox Size | 1.8 cubic feet | Glass Dimensions | 19¼” x 11¼” |
| | Chimney | 5 inch liner | Patent Numbers | 7/325,547 & 9/476,593 |

FUSION 24

Wood Burning Fireplace Insert

The Fusion 24 insert seamlessly introduces modern-day technology to any existing fireplace. With its tasteful, contemporary design and expansive firebox – among the industry’s largest – the Fusion 24 ensures you don’t forfeit the beauty of your masonry while improving the heating and comfort of your home.

Its flush-mount surround complements a multitude of decorating themes and its impressive viewing panel ensures that the compelling beauty of the fire is always the centerpiece. The Fusion’s sleek style is equaled by the sophistication of its engineering, with several patented technologies that underpin its peerless operation, providing instant ignition at the push of a button and long-lasting fires that exude fewer emissions.

The Fusion 24 offers an attractive way to update an old fireplace with the very latest heating technology.

| | | | | |
|----------------|------------------|---|------------------|--|
| SPECIFICATIONS | Heat Capacity | 2,000 square feet | Certifications | EPA 28 & 5G option 3, CSA B-415.1.10, UL 1482 and ULC S628 |
| | Max. Heat Output | 90,000 BTUs/hour (based on a 33 lb load of wood) | Emissions | 4.4 g/hr |
| | EPA Firebox Size | 2.4 cubic feet | Glass Dimensions | 22¾" x 12¼" |
| | Chimney | 5 inch liner | Patent Numbers | 7/325,547 & 9/476,593 |



| Exclusive Features & Technologies | GALAXY CLASSIC | GALAXY MODERN | GALAXY CONTEMPORARY | ASTRA 24CF | ASTRA 24TD | DUET/ 4 SEASONS | VISION | FUSION 18 | FUSION 24 |
|-----------------------------------|----------------|---------------|---------------------|------------|------------|--------------------------|--------------------------|--------------------------|--------------------------|
| Stainless Steel Firebox | ● | ● | ● | ● | ● | ● | ● | ● | ● |
| Premium Quality Blower | 130 CFM | 130 CFM | 130 CFM | 130 CFM | 130 CFM | 2 blowers, 155 CFM total | 2 blowers, 155 CFM total | 2 blowers, 110 CFM total | 2 blowers, 110 CFM total |
| Built-In Barbecue Grill | ● | ● | ● | | | ● | ● | ● | ● |
| Sealed Ash Pan | ● | ● | ● | | | ● | ● | | |
| Removable Ash Lip | ● | ● | ● | ● | ● | ● | ● | ● | ● |
| Easy-Light Control* | ● | ● | ● | | | ● | ● | | |
| Chimney Sweeping Cap | ● | ● | ● | ● | ● | ● | ● | ● | ● |
| Unique Door Operation | ● | ● | ● | ● | ● | ● | ● | ● | ● |
| Hot Air System | ● | ● | ● | ● | ● | ● | | | |
| Innovative Baffle Design | ● | ● | ● | ● | ● | ● | ● | ● | ● |
| Variable Secondary Air Control* | ● | ● | ● | ● | ● | ● | ● | ● | ● |
| Automatic Air Control* | ● | ● | ● | ● | ● | ● | ● | ● | ● |
| Cast-Iron Panels | | | | ● | ● | | | | |

*Patented



STAINLESS STEEL FIREBOX

A result of more than 30 years of pioneering research and development, our combustion chamber provides superior heat transfer; within minutes of lighting, radiant warmth will be permeating your home.

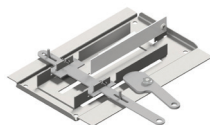

PATENTED AUTOMATIC AIR CONTROL

This patented, user-friendly mechanism automatically reduces the amount of combustion air introduced during ignition to the desired burn rate setting. The result is a beautifully consistent fire burning to its full capacity.



CAST-IRON PANELS

An extra layer of durability and strength is provided with these cast-iron panels that line our heavy-duty stainless steel firebox. In addition to providing a quicker and more uniform heat transfer, the cast-iron prolongs the combustion by retaining warmth.



SEALED ASH PAN

Simple and mess-free: ashes fall through a perforated grate into the sealed ash pan that is effortlessly removed and emptied.



REMOVABLE ASH LIP

Offering another layer of protection against ashes, this removable accessory can be attached below the door to prevent spills when the fireplace is opened.

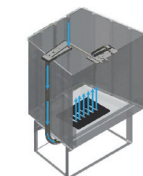

EASY-LIGHT CONTROL

There is no need to bother with kindling wood or newspaper when lighting our products. The patented easy-light mechanism releases a quick boost of air to aid ignition, ensuring warming your home is as simple as pushing a button.

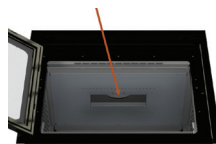

CHIMNEY SWEEPING CAP

Located on the baffle, this convenient feature allows the chimney to be easily accessed for cleaning, without requiring the removal of any components.



UNIQUE DOOR OPERATION

Our finely crafted door handle has an ergonomic design and keeps the door shut by means of a latch for a secure operation.

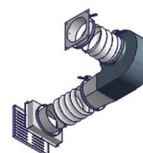

HOT AIR SYSTEM

This option helps distribute warm air to different floors or areas as far as 25 feet away.



INNOVATIVE BAFFLE DESIGN

Most EPA units have secondary air tubes that reduce the firebox height and require maintenance. Our unique design allows secondary air to enter through a perforated baffle offering an unimpeded view of the fire all while increasing the efficiency and combustion.



PATENTED VARIABLE AIR CONTROL

A variable amount of secondary air is introduced into the firebox that mixes with the rising gases of the wood. The result is an appealing and unique arrangement of flames that prolongs combustion, increases efficiency and minimizes emissions.

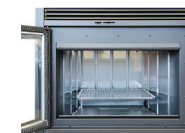

BUILT-IN BARBECUE GRILL

Avid barbecue fans will love this built-in accessory! Simply drop down the grill over embers to cook memorable meals imbued with flavorful smokiness all year-round.

GALAXY CLASSIC

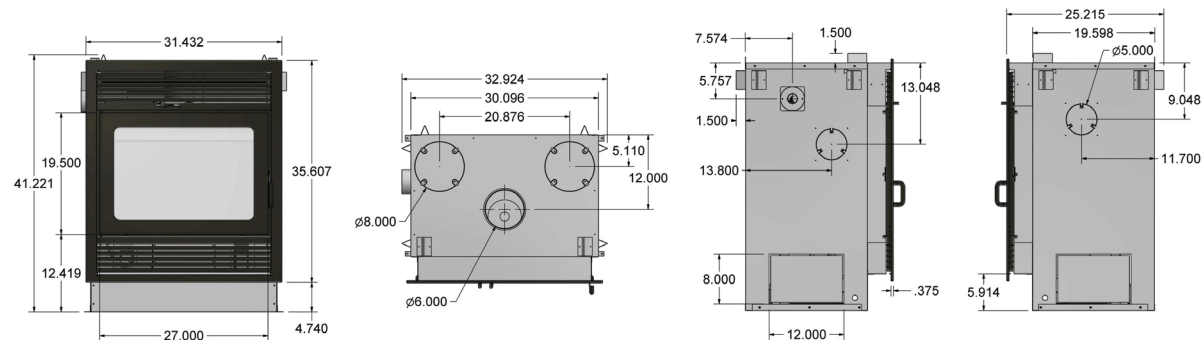

GALAXY MODERN

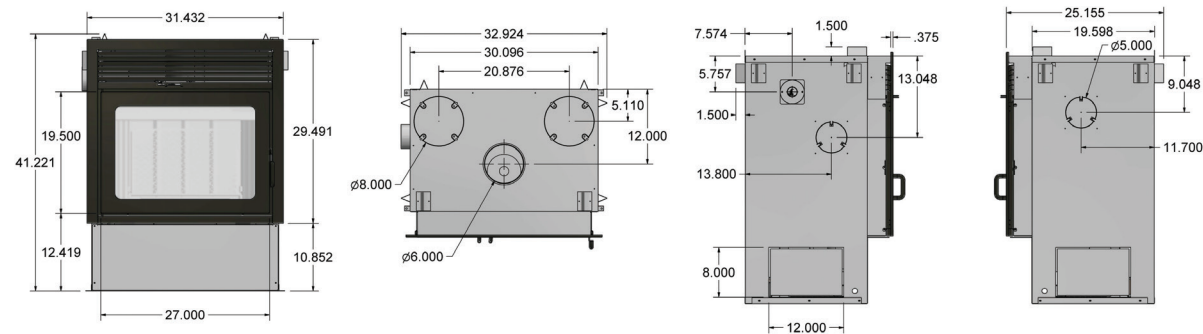

GALAXY CONTEMPORARY

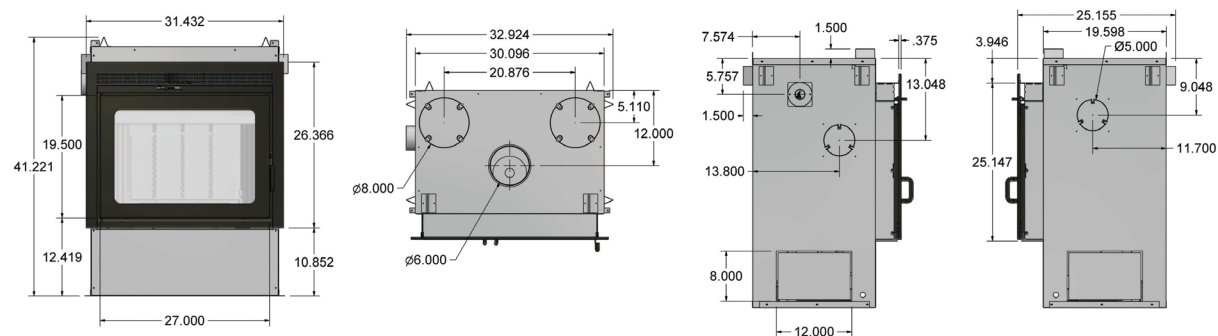

ASTRA 24CF

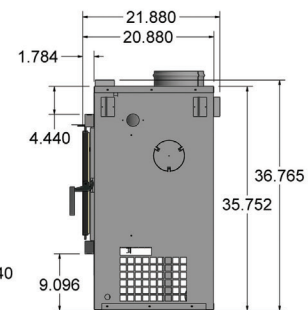
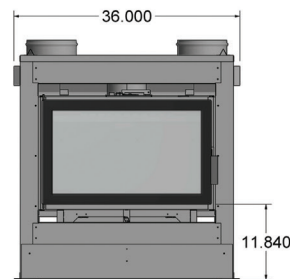
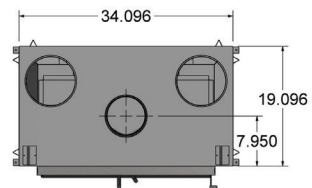
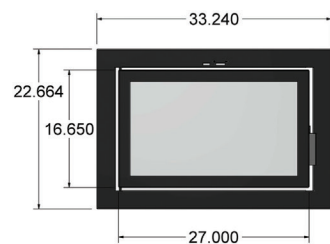

ASTRA 24TD

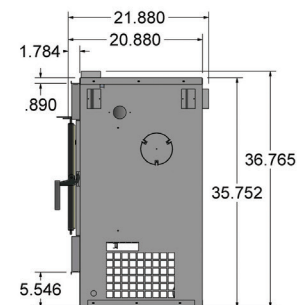
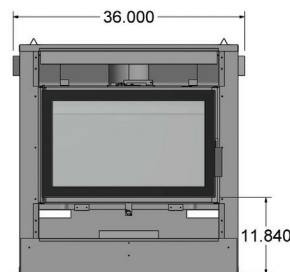
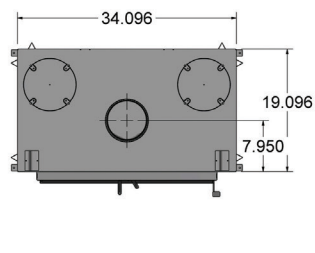
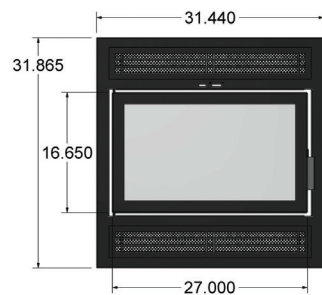

DUET /
DUET 4 SEASONS

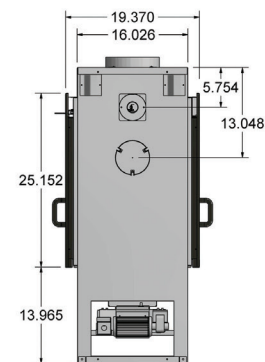
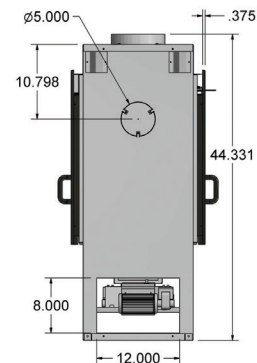
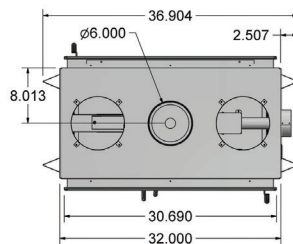
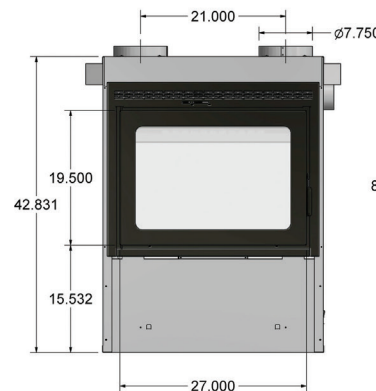

FUSION 18

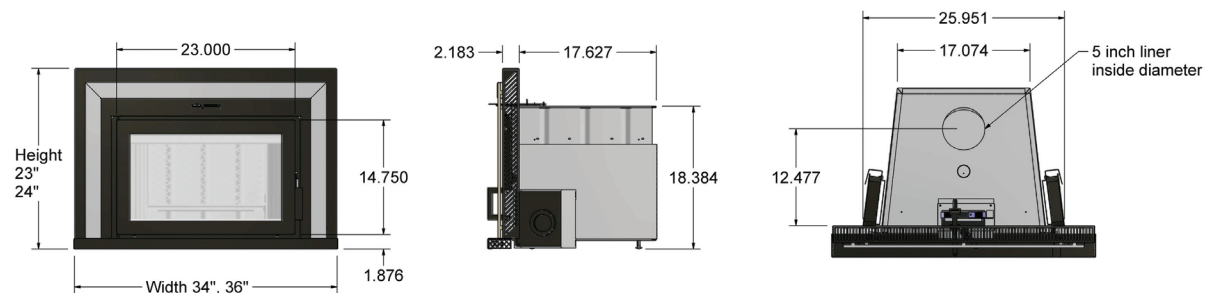

FUSION 24

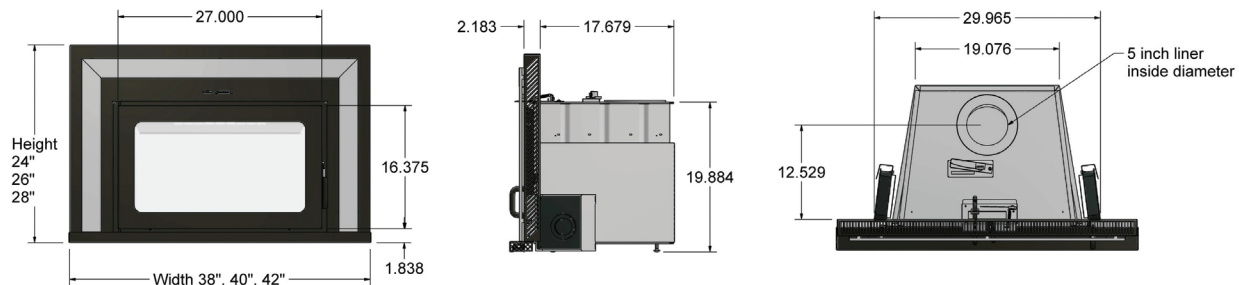

VISION

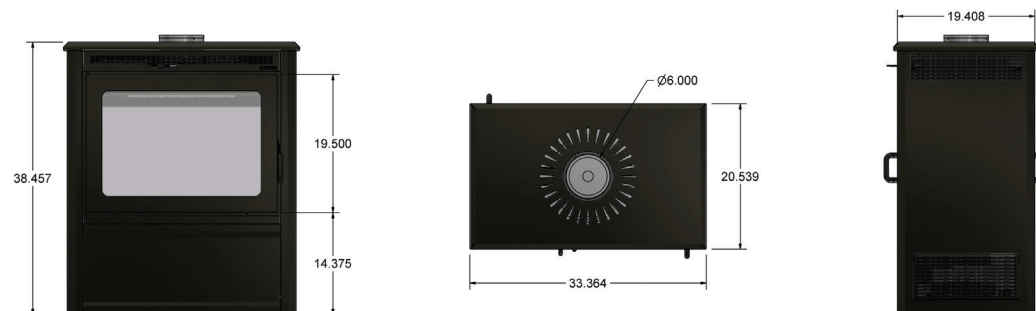

FUSION 18

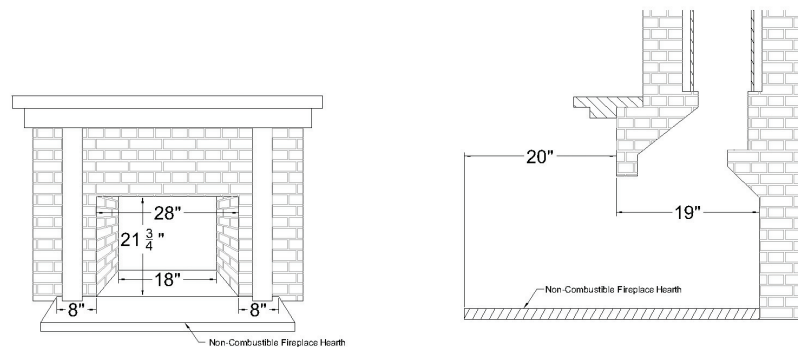

FUSION 24

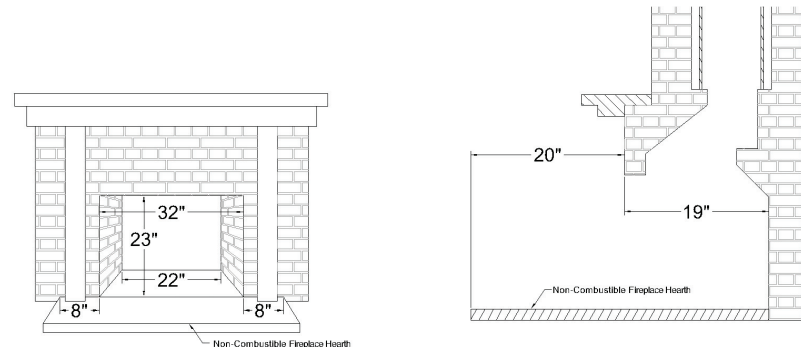

VISION

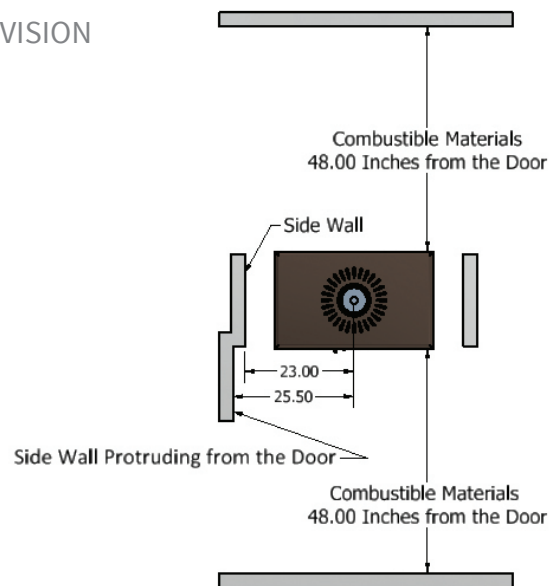

DUET

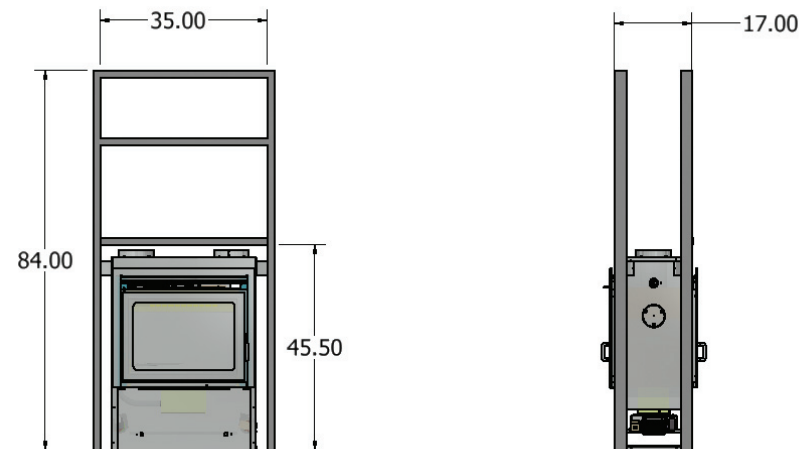

ASTRA

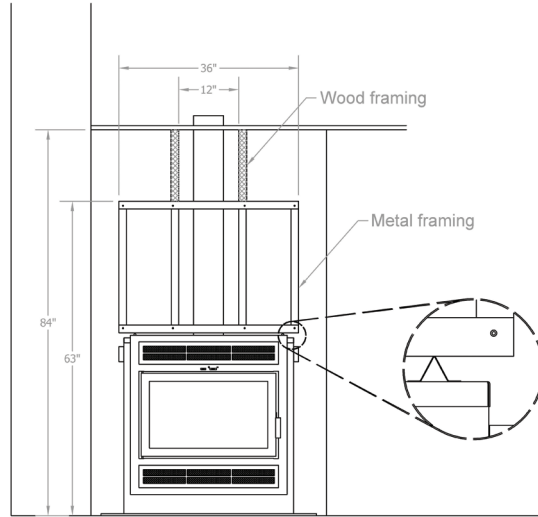

ASTRA CORNER INSTALLATION

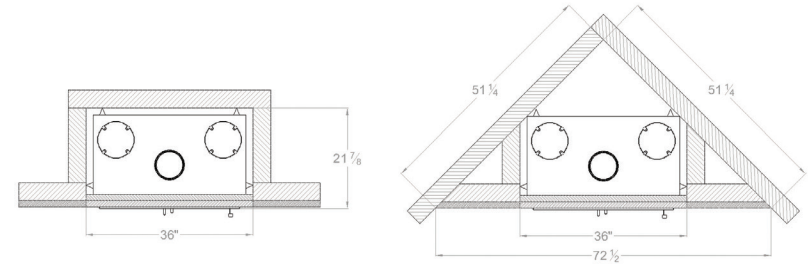

GALAXY

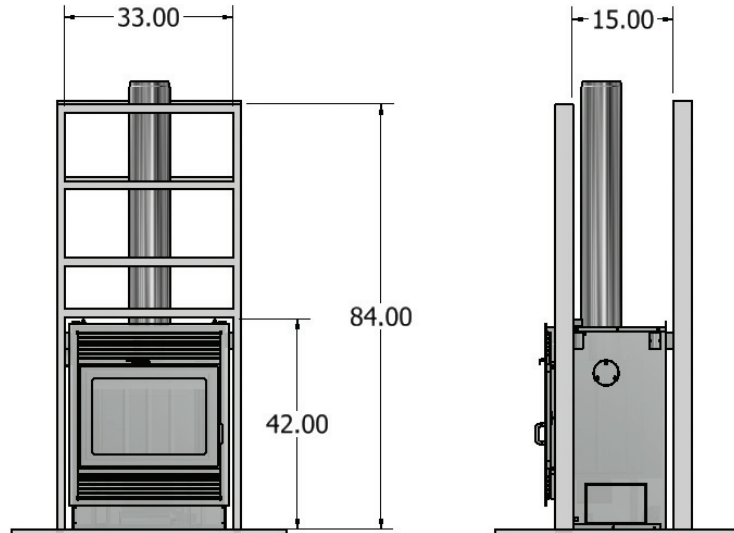

GALAXY CORNER INSTALLATION

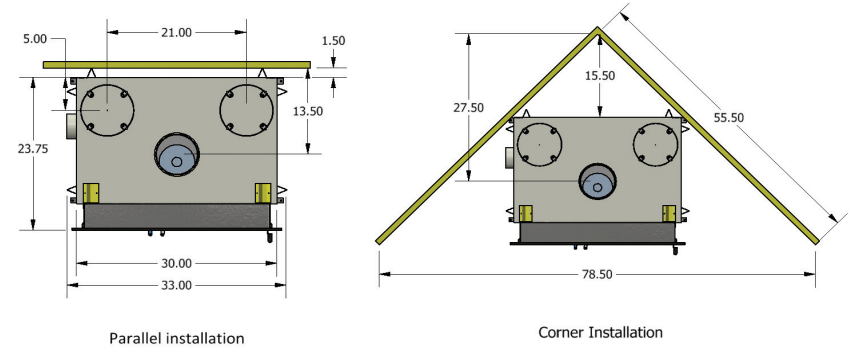

COMPANY COMMITMENTS...

Environmental Promise

Our products meet the most stringent EPA emissions requirements but that is not the only benchmark we strive to achieve. We are passionately committed to implementing environmentally sound practices in all aspects of our business.

For example, we use minimal insulation in our products as it contains microfibers that can be hazardous when inhaled. We also employ special techniques when welding our fireboxes to decrease the harmful gases released. Finally, our products are packaged in recycled material to lessen landfill.

We are dedicated to helping create a sustainable future for generations to come.



Innovation Promise

Our products represent the cutting-edge of engineering sophistication. For more than 30 years, we have pioneered technological advancements that have redefined the art of modern fireplace design.

Accordingly, our products boast patented features that ensure they are environmentally friendly, easy to use and offer unparalleled home heating. These innovations have been recognized in the form of accolades, including multiple prestigious Vesta awards.

Quality Promise

Every Supreme product embodies the very highest standards of workmanship and design excellence. An iron-clad control on quality is maintained by manufacturing almost every component in our state-of-the-art factory.

What's more, our products are exclusively handled by a network of experienced dealers and technicians so buyers always receive the utmost in service and support. When a customer chooses a Supreme product, they are investing in a high-caliber centerpiece to their home that will stand the test of time; we guarantee this with a market-leading limited lifetime warranty.





SUPREME

3594 Jarry East,
Montreal, Quebec H1Z 2G4

Telephone: 514 593.4722

Toll-free: 1 877 593.4722

Facsimile: 514 593.4424

www.supremem.com

info@supremem.com

