



**Dealer Pricing & Program**

# Table of Contents

## ZERO CLEARANCE FIREPLACES

Galaxy ..... 4-5

Astra 24 ..... 6-7

## SEE-THROUGH FIREPLACE

Duet ..... 8-9

## SEE-THROUGH STOVE

Vision ..... 10-11

## FIREPLACE INSERTS

Fusion 18 ..... 12-13

Fusion 24 ..... 14-15

Exclusive Features & Technologies ..... 16-17

Display Program ..... 18

Company Commitments ..... 19



GALAXY



## Zero Clearance Wood Burning Fireplace

Introduce a universe of comfort and warmth with the award-winning Galaxy. This large zero clearance fireplace proposes a versatile design that is offered in three different surround options to suit all decors: Classic, Modern and Contemporary. Among its many features, the Galaxy comes completely assembled with a heat-activated blower, a sealed ash pan, a built-in barbecue grill and a patented automatic air control.

### TECHNICAL SPECIFICATIONS

**Heat Capacity:** 2,500 square feet

**Max. Heat Output:** 100,000 BTUs/hour  
(based on a 33 lb load of wood)

**EPA Firebox Size:** 3.1 cubic feet

**Chimney:** 6 inch listed to UL 103/  
ULC S629 standards

**Certifications:** EPA 28 & 5G option 3, CSA B-415.1.10,  
UL 127-2011 and ULC S610-M87

**Emissions:** 3.5 g/hr with EPA method 28 & 5G  
2.2 g/hr with CSA method B-415.1.10

**Glass Dimensions:** 22 ¾" x 15"

**Patent Numbers:** 9/605,851, 7/325,547 & 9/476,593

PRODUCT CODE	DESCRIPTION	SUGGESTED RETAIL
GY-01	Galaxy, firebox and door in metallic black	\$ 3 813.60
GY-02	Galaxy, firebox and door in charcoal	\$ 3 813.60

### OPTIONS FOR REQUIRED FACE ASSEMBLY

*Must select one of the following assembly faces to complete order*

GYFA-111	Galaxy Classic face assembly in metallic black	\$ 263.32
GYFA-112	Galaxy Modern face assembly in metallic black	\$ 263.32
GYFA-113	Galaxy Contemporary face assembly in metallic black	\$ 263.32
GYFA-211	Galaxy Classic face assembly in metallic charcoal	\$ 263.32
GYFA-212	Galaxy Modern face assembly in metallic charcoal	\$ 263.32
GYFA-21	Galaxy Contemporary face assembly in charcoal	\$ 263.32
UCAC8 3	Gravity duct: 8 inch insulated, 10 feet long (two are required for the installation of the Contemporary face assembly)	\$ 171.61

### ADDITIONAL OPTIONS

SU250	Hot air system 245 CFM	\$ 440.20
UCAC5	5 inch insulated duct, 25 feet long (for hot air system)	\$ 141.08
UPEA4	Fresh air kit	\$ 84.08
ADP4	Adaptor for fresh air kit	\$ 43.58
CAPSPBN	Brushed Stainless Steel Door Capping	\$ 239.33
6CON	Connector from prefabricated chimney to liner	\$ 69.12





MODERN



CLASSIC



CONTEMPORARY





# ASTRA 24

## Zero Clearance Wood Burning Fireplace

Thanks to its compact depth, the Astra 24 can seamlessly be installed into an existing wall to replace an old decorative unit while providing all the visual appeal of a large fireplace. The ingenious design of the firebox features cast-iron panels for extreme durability and prolonged burn times. Patented ignition and air control systems allow spaces of up to 1,500 square feet to be warmed with ease. The Astra’s high efficiency is also matched by its environmental credentials with an EPA certification of 1.8 g/hr.

### TECHNICAL SPECIFICATIONS

Heat Capacity:	1,500 square feet
Max. Heat Output:	75,000 BTUs/hour (based on a 33 lb load of wood)
EPA Firebox Size:	2.4 cubic feet
Chimney:	6 inch listed to UL 103/ ULC S629 standards
Certifications:	EPA 28 & 5G option 3, CSA B-415.1.10, UL 127-2011 and ULC S610-M87
Emissions:	1.8 g/hr
Glass Dimensions:	24" x 13½"
Patent Numbers:	7/325,547 & 9/476,593

PRODUCT CODE	DESCRIPTION	SUGGESTED RETAIL
24AT-01	Astra 24, firebox and door in Metallic Black	\$ 3 336.90

### OPTIONS FOR REQUIRED FACE ASSEMBLY

*Must select one of the following assembly faces to complete order*

24ATFA-11	Astra 24 Traditional surround in metallic black	\$ 263.32
24ATFA-12	Astra 24 Clean Face surround in metallic black	\$ 263.32
UCAC8	Gravity duct: 8 inch insulated, 10 feet long (two are required for the installation of the Clean Face.)	\$ 171.61

### ADDITIONAL OPTIONS

SU250	Hot air system 245 CFM	\$ 440.20
UCAC5	5 Inch insulated duct, 25 feet long (for hot air system)	\$ 153.54
UPEA4	Fresh air kit	\$ 96.11
ADP4	Adaptor fresh air kit	\$ 45.76
CAPSPBN	Connector from prefabricated chimney to liner	\$ 219.87
6CON	Connector from prefabricated chimney to liner	\$ 82.95



# DUET

## See-Through Wood Burning Fireplace

The Duet doubles as a visually compelling feature in any interior scheme, whether installed as a centerpiece or as a decorative divider between two rooms. Several patented technologies ensure user-friendly ignition that can effortlessly warm spaces of 2,000 square feet. As the only double-sided wood burning fireplace to meet the EPA's most exacting emission standards, it confirms Supreme's position as the industry leader of clean burn technology and embodies its long legacy of innovation.

### TECHNICAL SPECIFICATIONS

Heat Capacity:	2,000 square feet
Max. Heat Output:	100,000 BTUs/hour (based on a 33 lb load of wood)
EPA Firebox Size:	3.1 cubic feet
Chimney:	6 inch listed to UL 103/ ULC S629 standards
Certifications:	EPA 28 & 5G option 3, CSA B-415.1.10, UL 127-2011 and ULC S610-M87
Emissions:	3.6 g/hr with EPA method 28 & 5G 2.2 g/hr with CSA method B-415.1.10
Glass Dimensions:	22¾" x 15"
Patent Numbers:	9/605,851, 7/325,547 & 9/476,593

PRODUCT CODE	DESCRIPTION	SUGGESTED RETAIL
DT-01	Duet, see-through fireplace in metallic black	\$ 4 707.41
DT-02	Duet, see-through fireplace in charcoal	\$ 4 707.41
UCAC8	Gravity duct: 8 inch insulated, 10 feet long (two are required for the installation of the Duet)	\$ 171.61

### OPTIONS

DT2317	Block-off shield for 4 Seasons configuration (indoor/outdoor installation)	\$ 92.96
SU250	Hot air system 245 CFM	\$ 440.20
UCAC5	5 inch insulated duct, 25 feet long for hot air system	\$ 141.08
UPEA4	Fresh air kit	\$ 84.08
ADP4	Adaptor for fresh air kit	\$ 43.58
6CON	Connector from prefabricated chimney to liner	\$ 79.00





DUET



VISION



## See-Through Fireplace

As the industry's first and only see-through wood burning stove, the Vision is a masterpiece of engineering foresight. Thanks to its double-sided design and large glass doors that attractively display the beauty of the fire from both sides, the Vision acts as a compelling centrepiece in a room. Patented ignition and air control systems ensure optimum performance and unparalleled functionality. Available in a variety of different colors, the Vision comes fully equipped with two heat-activated blowers, a sealed ash pan and built-in barbecue grills.

### TECHNICAL SPECIFICATIONS

**Heat Capacity:** 2,000 square feet

**Max. Heat Output:** 100,000 BTUs/hour  
(based on a 33 lb load of wood)

**EPA Firebox Size:** 3.1 cubic feet

**Chimney:** 6 inch listed to UL 103/ULC S629

**Certifications:** EPA 28 & 5G option 3, CSA B-415.1.10,  
UL 127-2011 and ULC S610-M87

**Emissions:** 3.6 g/hr with EPA method 28 & 5G  
2.2 g/hr with CSA method B-415.1.10

**Glass Dimensions:** 22¾"x 15"

**Patent Numbers:** 9/605,851, 7/325,547 & 9/476,593

PRODUCT CODE	DESCRIPTION	SUGGESTED RETAIL
VI-01	Vision, see-through stove in metallic black	\$ 4 290.30
VI-02	Vision, see-through stove in charcoal	\$ 4 290.30
VI-41	Vision, see-through stove in metallic black with mojave red	\$ 4 290.30
VI-51	Vision, see-through stove in metallic black with almond	\$ 4 290.30
VI-61	Vision, see-through stove in metallic black with honey glo brown	\$ 4 290.30
VI-SS1	Vision, see-through stove in metallic black with stainless steel	\$ 5 005.35

### AVAILABLE COLORS:



Metallic Black



Charcoal



Mojave Red



Honey Glo Brown



Almond



Stainless Steel





VISION



# FUSION 18

## Wood Burning Fireplace Insert

Transform an old energy-draining fireplace into an eco-friendly, efficient heat source with the Fusion. Available in two firebox sizes, it can easily be installed into a variety of masonry openings. Several patented technologies underpin its peerless operation, providing instant ignition at the push of a button and long-lasting fires that exude fewer emissions. Its sleek design and innovative technologies introduce comfort, without forfeiting the beauty of the existing masonry.

### TECHNICAL SPECIFICATIONS

Heat Capacity:	1,500 square feet
Max. Heat Output:	75,000 BTUs/hour (based on a 33 lb load of wood)
EPA Firebox Size:	1.8 cubic feet
Chimney:	5 inch liner
Certifications:	EPA 28R, ASTM E2780, ASTM E2515, CSA B415.1-10, UL 1482 and ULC S628
Emissions:	1.9 g/hr
Glass Dimensions:	19¼" x 11¼"
Patent Numbers:	7/325,547 & 9/476,593

PRODUCT CODE	DESCRIPTION	SUGGESTED RETAIL
18FN-01	Fusion 18, fireplace insert in metallic black	\$ 2 028.02
18FN-02	Fusion 18, fireplace insert in charcoal	\$ 2 028.02

### OPTIONS *(select one of the following surrounds to complete order)*

18FNFA-01-34	Surround in metallic black (34" x 23")	\$ 240.62
18FNFA-01- 36	Surround in metallic black (36" x 24")	\$ 263.32
18FNFA-02-34	Surround in charcoal (34" x 23")	\$ 240.62
18FNFA-02-36	Surround in charcoal (36" x 24")	\$ 240.62
18FNFA-01SS- 34	Surround in metallic black and brushed stainless steel (34" x 23")	\$ 431.30
18FNFA-01SS- 36	Surround in metallic black and brushed stainless steel (36" x 24")	\$ 454.00
18FNFA-02SS- 34	Surround in charcoal and brushed stainless steel (34" x 23")	\$ 431.30
18FNFA-02SS-36	Surround in charcoal and brushed stainless steel (36" x 24")	\$ 454.00



FUSION 18





# FUSION 24

## Wood Burning Fireplace Insert

### TECHNICAL SPECIFICATIONS

Heat Capacity:	2,000 square feet
Max. Heat Output:	90,000 BTUs/hour (based on a 33 lb load of wood)
EPA Firebox Size:	2.4 cubic feet
Chimney:	5 inch liner
Certifications:	EPA 28 & 5G option 3, CSA B-415.1.10, UL 1482 and ULC S628
Emissions:	4.4 g/hr
Glass Dimensions:	22¾" x 12¼"
Patent Numbers:	7/325,541, 9/476,593, 9/488,375

PRODUCT CODE	DESCRIPTION	SUGGESTED RETAIL
FN-01	Fusion 24, fireplace insert in metallic black	\$ 2 129.42
FN-02	Fusion 24, fireplace insert in charcoal	\$ 2 129.42

### OPTIONS FOR REQUIRED FACE ASSEMBLY

Must select one of the following assembly faces to complete order

FNFA-01-38	Surround in metallic black (38" x 24")	\$ 252.65
FNFA-01-40	Surround in metallic black (40" x 26")	\$ 276.49
FNFA-02-42	Surround in metallic black (42" x 28")	\$ 300.32
FNFA-02-38	Surround in charcoal (38" x 24")	\$ 252.65
FNFA-02- 40	Surround in charcoal (40" x 26")	\$ 276.49
FNFA-02-42	Surround in charcoal (42" x 28")	\$ 300.32
FNFA-01SS-38	Surround in metallic black and brushed stainless steel (38" x 24")	\$ 452.87
FNFA-01SS-40	Surround in metallic black and brushed stainless steel (40" x 26")	\$ 476.70
FNFA-01SS-42	Surround in metallic black and brushed stainless steel (42" x 28")	\$ 500.54
FNFA-02SS-38	Surround in charcoal and brushed stainless steel (38" x 24")	\$ 452.87
FNFA-02SS-40	Surround in charcoal and brushed stainless steel (40" x 26")	\$ 476.70
FNFA-02SS-42	Surround in charcoal and brushed stainless steel (42" x 28")	\$ 220.50

### OPTIONS

CAPVPBN	Brushed Stainless Steel Door (capping only)	\$ 105.43
---------	---	-----------



FUSION 24





Exclusive Features & Technologies	GALAXY CLASSIC	GALAXY MODERN	GALAXY CONTEMPORARY	ASTRA 24CF	ASTRA 24TD	DUET/ 4 SEASONS	VISION	FUSION 18	FUSION 24
Stainless Steel Firebox	●	●	●	●	●	●	●	●	●
Premium Quality Blower	130 CFM	130 CFM	130 CFM	130 CFM	130 CFM	2 blowers, 155 CFM total	2 blowers, 155 CFM total	2 blowers, 110 CFM total	2 blowers, 110 CFM total
Built-In Barbecue Grill	●	●	●			●	●	●	●
Sealed Ash Pan	●	●	●			●	●		
Removable Ash Lip	●	●	●	●	●	●	●	●	●
Easy-Light Control*	●	●	●			●	●		
Chimney Sweeping Cap	●	●	●	●	●	●	●	●	●
Unique Door Operation	●	●	●	●	●	●	●	●	●
Hot Air System	●	●	●	●	●	●			
Innovative Baffle Design	●	●	●	●	●	●	●	●	●
Variable Secondary Air Control*	●	●	●	●	●	●	●	●	●
Automatic Air Control*	●	●	●	●	●	●	●	●	●
Cast-Iron Panels				●	●				

\*Patented





### STAINLESS STEEL FIREBOX

A result of more than 30 years of pioneering research and development, our combustion chamber provides superior heat transfer; within minutes of lighting, radiant warmth will be permeating your home.

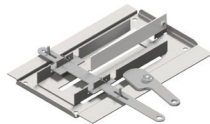

### PATENTED AUTOMATIC AIR CONTROL

This patented, user-friendly mechanism automatically reduces the amount of combustion air introduced during ignition to the desired burn rate setting. The result is a beautifully consistent fire burning to its full capacity.



### CAST-IRON PANELS

An extra layer of durability and strength is provided with these cast-iron panels that line our heavy-duty stainless steel firebox. In addition to providing a quicker and more uniform heat transfer, the cast-iron prolongs the combustion by retaining warmth.



### SEALED ASH PAN

Simple and mess-free: ashes fall through a perforated grate into the sealed ash pan that is effortlessly removed and emptied.



### REMOVABLE ASH LIP

Offering another layer of protection against ashes, this removable accessory can be attached below the door to prevent spills when the fireplace is opened.

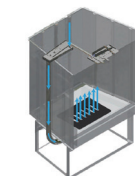

### EASY-LIGHT CONTROL

There is no need to bother with kindling wood or newspaper when lighting our products. The patented easy-light mechanism releases a quick boost of air to aid ignition, ensuring warming your home is as simple as pushing a button.



### CHIMNEY SWEEPING CAP

Located on the baffle, this convenient feature allows the chimney to be easily accessed for cleaning, without requiring the removal of any components.



### UNIQUE DOOR OPERATION

Our finely crafted door handle has an ergonomic design and keeps the door shut by means of a latch for a secure operation.

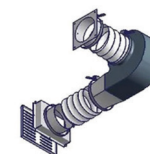

### HOT AIR SYSTEM

This option helps distribute warm air to different floors or areas as far as 25 feet away.



### INNOVATIVE BAFFLE DESIGN

Most EPA units have secondary air tubes that reduce the firebox height and require maintenance. Our unique design allows secondary air to enter through a perforated baffle offering an unimpeded view of the fire all while increasing the efficiency and combustion.



### PATENTED VARIABLE AIR CONTROL

A variable amount of secondary air is introduced into the firebox that mixes with the rising gases of the wood. The result is an appealing and unique arrangement of flames that prolongs combustion, increases efficiency and minimizes emissions.



### BUILT-IN BARBECUE GRILL

Avid barbecue fans will love this built-in accessory! Simply drop down the grill over embers to cook memorable meals imbued with flavorful smokiness all year-round.

# DISPLAY PROGRAM

## BURNING UNIT

Receive a 100% burn credit for each SUPREME product installed, finished and functional in a dealer's showroom.

### CONDITIONS

1. The fireplace must be built-in and functional in the showroom.
2. A "Burn/Static Display Credit Request" form, with a photograph of the unit burning, a serial number, and a sales rep's signature must be submitted.
3. The dealer must purchase 4 additional fireplaces throughout the next 12 months after installing the burning unit. The fireplaces can be a mix of products.

**Once a picture of the unit burning is submitted, a 50 % burn credit will be issued. If the dealer purchases 4 additional units during the following 12 months, a credit for the remaining balance of the burn unit will be issued. A displaying unit does not qualify as a purchase towards a 100% burn credit.**

## STATIC UNIT

Receive up to 20 % additional credit for any static display of a SUPREME product in a dealer's showroom.

### CONDITIONS

1. The unit must be built-in and well presented in the showroom.
2. A "Burn/Static Display Credit Request" form, with a photograph of the unit, a serial number, and a sales rep's signature must be submitted.

***Once a picture of the unit built in to the showroom is submitted, a 20 % static display credit will be issued.***

# COMPANY COMMITMENTS...

## Environmental Promise

Our products meet the most stringent EPA emissions requirements but that is not the only benchmark we strive to achieve. We are passionately committed to implementing environmentally sound practices in all aspects of our business.

For example, we use minimal insulation in our products as it contains microfibers that can be hazardous when inhaled. We also employ special techniques when welding our fireboxes to decrease the harmful gases released. Finally, our products are packaged in recycled material to lessen landfill.

We are dedicated to helping create a sustainable future for generations to come.



## Innovation Promise

Our products represent the cutting-edge of engineering sophistication. For more than 30 years, we have pioneered technological advancements that have redefined the art of modern fireplace design.

Accordingly, our products boast patented features that ensure they are environmentally friendly, easy to use and offer unparalleled home heating. These innovations have been recognized in the form of accolades, including multiple prestigious Vesta awards.

## Quality Promise

Every Supreme product embodies the very highest standards of workmanship and design excellence. An iron-clad control on quality is maintained by manufacturing almost every component in our state-of-the-art factory.

What's more, our products are exclusively handled by a network of experienced dealers and technicians so buyers always receive the utmost in service and support. When a customer chooses a Supreme product, they are investing in a high-caliber centerpiece to their home that will stand the test of time; we guarantee this with a market-leading limited lifetime warranty.





SUPREME

3594 Jarry East,  
Montreal, Quebec H1Z 2G4

Telephone: 514 593.4722

Toll-free: 1 877 593.4722

Facsimile: 514 593.4424

[www.supremem.com](http://www.supremem.com)

[info@supremem.com](mailto:info@supremem.com)

